



Uttarbanga Kshetriya Gramin Bank
Head Office: Sunity Road
Coochbehar 736101
West Bengal
Ph. No: 03582-229301 to 303

Tender Notice

Sealed Tenders are invited by Head Office-Uttarbanga Kshetriya Gramin Bank,Sunity Road,Coochbehar-736101,West Bengal for our Rathkhola Branch from Authorized Contractor to execute composite work which includes Interior, Furnishing, and other associated works under (Two) bid system i.e. Technical Bid (Cover-I) & Price Bid (Cover-II). Interested party may collect Tender Document which will be treated as part of this notice from our GAD Deaprtment,1st Floor,UBKGB,Head Office,Sunity Road,Coochbehar-736101. or from our website www.ubkgb.org .Complete quotation in sealed envelope to be submitted in the tender box kept at our GAD Deaprtment,1st Floor,UBKGB,Head Office,Sunity Road,Coochbehar-736101 within 15-10-2016.

Uttar Banga Kshetriya Gramin Bank reserve the right to accept partly or fully any quotation or reject any or all quotations without assigning any reason whatsoever and not bound to accept the lowest quotation.

S.C.Gupta
General Manager

TECHNICAL BID
FOR
INTERIOR & FURNISHING WORK
OF
RATHKHOLA BRANCH OF
UTTARBANGA KSHETRIYA GRAMIN BANK

UTTARBANGA KSHETRIYA GRAMIN BANK

(Sponsored by Central Bank of India)

Head Office : Sunity Road

Coochbehar : 736101 (West Bengal)

TENDER INVITATION

Sealed tenders are invited by Head office - Uttarbanga Kshetriya Gramin Bank, Sunity Road, Coochbehar – 736101, West Bengal for its **RATHKHOLA BRANCH** from **only empanelled contractors of Central Bank of India (Siliguri Region Only)** to execute composite work which includes Furnishing, and other associated works under (Two) bid System i.e. Technical Bid (Cover-I) & Price Bid (Cover-II).

Name of Work: **Interior Furnishing, Furbishing** and allied works of **RATHKHOLA BRANCH** (Allied Works) of Uttarbanga Kshetriya Gramin Bank.

Availability of Tender Documents: Uttarbanga Kshetriya Gramin Bank
Head Office
Sunity Road
Coochbehar - 736101
West Bengal

Issue of the Tender Documents: From 18-09-2016 to 15-10-2016
between 10:00 Hrs to 15:30 Hours, Except Sundays and
Holidays

**Time & date of Submission of:
Tender** Up to 12:00 P.M. on 15-10-2016

**Time and Date of Opening of
Tender** Tender will be open as per bank's decided date &
time.

Envelope-I:
Shall contain all the covering letter with the Earnest Money
Along with the tender document duly signed

Envelope- II
Shall contain the Price Bid, dully filled in the Provided
Price Bid Tender Document.

Venue of the Tender opening: Uttarbanga Kshetriya Gramin Bank
Head Office
Sunity Road
Coochbehar - 736101
West Bengal

Tender to be addressed to:	Uttarbanga Kshetriya Gramin Bank Head Office Sunity Road Coochbehar - 736101 West Bengal
Earnest Money:	10,000.00/- (Rupees Ten Thousand Only) The Tenderer must submit an EMD as mentioned in the form of a demand draft/ pay order only in favour of Uttarbanga Kshetriya Gramin Bank payable at Coochbehar drawn on any nationalized bank (and which shall not bear any interest). Tender without the Earnest Money in Proper form shall be rejected.
Delay in submission:	Delay in submission of any part arising due to postal or any other irregularities at any stage will not be considered. The Bank will not be responsible for any damage in transit in case of postal delivery/ delivery through courier service.
Defect Liability Period:	12(Twelve) months from the date of issue of completion certificate.
Date of Commencement:	Either one week from the date of acceptance of Work Order or the day on which the contractor is instructed to take possession of the site, whichever is later.
Period of Completion:	4 weeks from the starting of the work
Validity of the Tender:	3(Three) calendar months from the date of submission of Tender

MODE OF SUBMISSION

The tender is to be submitted in one envelope having both the envelopes I & II being put in the this one envelope and should be sealed properly and addressed to “Uttarbanga Kshetriya Gramin Bank, Head Office, Sunity Road, Coochbehar – 736101, West Bengal”

ENVELOPE 1: (Market As ENVELOPE I)

This envelope shall contain the following:

- a) Forwarding letter with quoted rates.
- b) The earnest money deposit furnished in form of crossed demand draft drawn in favor of Uttarbanga Kshetriya Gramin Bank and payable at Coochbehar for the amount indicated in the Notice of Invitation of Tender.
- c) Any comments which the tenderer desires to make in the form of statement as brief as possible and with reference to the items
- d) The terms and conditions which are of commercial and technical nature if any

ENVELOPE-2: Price Bid (MARKET AS ENVELOPE II)

This ENVELOPE shall contain the following

Envelope Marked II shall contain the Priced Bid submitted on the printed Forms issued by the bank. The tenderer shall quote the final figure both figure and words.

- Tenders in only printed form issued by the “Uttarbanga Kshetriya Gramin Bank, Head Office Coochbehar should be placed in sealed cover addressed to the “Uttarbanga Kshetriya Gramin Bank, Head Office, Sunity Road, Coochbehar – 736101, West Bengal”
- Delay in submission: Delay in submission of any part arising due to postal or any other irregularities at any stage will not be considered. The bank will not be responsible for any damage in transit in case of postal delivery/ delivery through courier service.
- All tenders in whom any of the prescribed conditions are not fulfilled or are incomplete in any respect are liable to be rejected
- The acceptance of the tender will rest with Uttarbanga Kshetriya Gramin Bank which does not bind itself to accept the lowest or any tender and reserves to itself the right to reject any or all the tenders received without assigning any reason/s thereof. The bank also reserves to itself the right of accepting the whole or any part of the tender and the tenderer shall be bound to perform the same at the rates quoted.

- In case the date of opening of the tender is declared as a holiday, the tender will be opened on the next working day.
- Conditional tenders will be summarily rejected.
- Retention Money: The Retention percentage (i.e. deduction from the Final Bill) shall be 10% of the gross value of the Bill. The retention Money shall be paid within 7 days of the completion of the defect liability period.
- After opening the envelope I no correspondence will be entertained.
- Prior to opening of the Price Bid, the Uttarbanga Kshetriya Gramin Bank/ its authorized personnel/architect at its discretion may inspect the on-going/completed project of the contractors as well as obtain confidential report from the concerned employers/clients.
- An item rate tender containing percentage below/above will be summarily rejected.
- On acceptance of the tender the name of the accredited representative(s) of the contractors who would be responsible for taking instructions from the client/bank shall be communicated to the bank/client.
- Sales tax, work contract tax, service tax or any other tax on material or on finished work in respect of this contract whether in vogue or likely to be imposed in future shall be payable by the contractor and the bank will not entertain any claim whatsoever in this respect at any time. Rates should include all these taxes.

All entries in Tender document must be made in ENGLISH. It must be hand written using black INK.

NOTE:

A 1. The contractor / tenderer means the person / the firm / the agency who is participating in the contract bid which shall also include their Legal Representatives, Successors, Hirers and Assignee of the firm.

2. Engineer-in-charge means, the Engineer/ Architect/ consultants/ specialized agency/ person appointed by the Uttarbanga Kshetriya Gramin Bank- Coochbehar Head Office who will be supervising the work, certifying the bill and who will also be responsible for the entire project.

a) Only the Tender form issued by Uttarbanga Kshetriya Gramin Bank- Coochbehar Head Office should be used for the process of tendering.

b) As far as possible corrections in the tender documents to be avoided. However in case of any corrections, the same should be authenticated by the person who is signing the tender. Over writing in the tender document is not permitted.

c) The tender should be forwarded in the official letter head of the tenderer.

4. The complete tender documents (duly signed tender conditions, specification, priced bill of quantities etc.) should be addressed to “Uttarbanga Kshetriya Gramin Bank, Head Office, Sunity Road, Coochbehar – 736101, West Bengal” and reach the office on or before date fixed and notified in the tender document as mentioned in the cover page.

5. The tenders will not be received after the due date and the time fixed. However, if the Uttarbanga Kshetriya Gramin Bank- Coochbehar Head Office desires to extend the time limit, it will do so by informing all the tenderer either before the due date and time fixed for submission or after the due date and time.

6. In case, the tenderer does not wish to quote for the work, the same should be informed to “Uttarbanga Kshetriya Gramin Bank, Head Office, Sunity Road, Coochbehar – 736101, West Bengal” over letter / fax addressed to The Head Office on or before the due date of submission of the tender.

7. The Head Office, Coochbehar will take no responsibility for delay or loss or non-receipt of tenders after dispatch, by the tenderer.

8. The tenderer are advised to hand over the duly filled tender directly to the office of “Uttarbanga Kshetriya Gramin Bank, Head Office, Sunity Road, Coochbehar – 736101, West Bengal” or ensure that the tender reaches the office before the due date fixed for submission of the tender.

9. The intending tenderer shall visit the site and make him thoroughly acquainted with the local site conditions, nature and requirements of the work, facilities of transport condition, effective labor and materials, access and storage for materials and removal of rubbish before quoting the rates. For this, the officials of bank may be contacted to make the arrangements.

10. The rate quoted should be inclusive of the cost carriage, freight of materials, labor, transportation loading/unloading, installation, and other charges as also for any special difficulties including restriction on transportation etc for proper execution of work as indicated in the drawings. The successful tenderer will not be entitled to any claim of compensation for difficulties faced or losses incurred on account of any site condition which existed before the commencement of the work or which in the opinion of the bank might be deemed to have reasonably been inferred to be so existing before the commencement of work.

11. The tender should be submitted strictly as per the terms & conditions spelt out in the tender notice. The tenderer should not make any alteration in the terms & conditions, drawings, specifications etc. In case of any alteration the tender may be considered as invalid/void.

12. Incomplete tenders are liable to be rejected.

B. Opening of the Tender:

1. The sealed tenders will be opened in the presence of the authorized official of the bank from Uttarbanga Kshetriya Gramin Bank- Coochbehar Head Office on the day and time as specified.

C. Acceptance of the tender:

1. The rates quoted by the contractors should be valid as specified in the cover page no 1.

2. Uttarbanga Kshetriya Gramin Bank- Coochbehar Head Office reserves the right to accept / reject summarily any / all tenders in whole or part there of without assigning any reason whatsoever and also do not bind it to accept the lowest or any other tender.

3. It will be open to Uttarbanga Kshetriya Gramin Bank- Coochbehar Head Office to negotiate the terms including the rates quoted with the lowest tenderer. The negotiated price by Head Office Coochbehar will be the contract value and work order will be placed for the said amount.

4. The tenders for the work shall remain for acceptance for a period as specified above or the period that may be extended by mutual agreement and the tenderers shall not cancel / withdraw the tenders during that period.

5. Each tenderer must submit an earnest money deposit as mentioned above in the form of a demand draft/ pay order only in favour of “Uttarbanga Kshetriya Gramin Bank” payable at Coochbehar drawn on any Nationalized bank (and which shall not bear any interest). The demand draft/ pay order .No tender will be accepted without EMD. The EMD will not carry any interest. In case of failure on the part of the contractor for commencement of work / delay in execution of the project, the said amount will be forfeited.

6. The earnest money will be returned to the unsuccessful tenderer after the intimation of rejection of the tender is sent. The earnest money will be retained in the case of the successful tenderer and will get converted as a part of security deposit for the due performance of the contract.

7. Earnest money deposit will be forfeited, if the contractor:

a. Revokes the tender or increases the earlier quoted rates within the validity period.

- b. Refuse, delay to sign and execute the contract after tender is accepted.
- c. Does not commence the work within the time specified in the letter of intent/work order or 7 days from the issue of such letter, whichever is later.

8. The tenders will be rejected;

- a. If the contractor does not quote any of the item / sub-item in the tender
- b. If the contractors makes any correction in the rate while quoting, not countersigned and duly stamped for the correction of that particular item of work.

9. The tenders which do not fulfill any of the prescribed conditions will not be accepted.

10. Canvassing in connection with the tender is strictly prohibited and tenders submitted by the contractors who resort to canvassing will be liable to rejection

D. Execution of Work:

The work should commence within the period specified on i.e.7days from the date of the receipt of work order or the date that may be indicated in the work order. Accordingly, date of commencement of the work will be reckoned from the day as specified above

2. The work should be completed as specified on the cover page calculated i.e. 4 weeks from the date of commencement of the work or within the time limit that may be indicated in the work order.

3. Time allowed for execution of work, as specified in tender, shall be the essence of the contract. However the tenderer shall plan the execution of the said work and it needs to be carried out without disturbing the running of the office or as per the client's instructions strictly within the schedule time as specified in the tender.

4. If the tenderer commits default in commencing the work, as required by the work order and found that the date stipulated cannot be adhered to, Uttarbanga Kshetriya Gramin Bank- Coochbehar Head Office shall be entitled without prejudice to any other rights or remedies available and/or may terminate / rescind the contract.

5. If the tenderer fails to carry out the work within the stipulated time mentioned in the work order, the Uttarbanga Kshetriya Gramin Bank- Coochbehar Head Office will have liberty to impose penalty Charges @0.2% per week of the value of the work will be made upon delay in completion of the work. Any decision in the matter by the bank shall be final.

6. However, if Uttarbanga Kshetriya Gramin Bank- Coochbehar Head Office is convinced that the delay in execution of the work is beyond the circumstances created by the tenderer, they may award extension of the same to the extent they feel justified based on the request of the tenderer.

In such case liquidated damages will be levied for the balance period, if any as provided as per the condition of the tender.

7. If the tenderer fails to commence the work within the specified days i.e. 7 days as from the date of receipt of intimation for commencement of the work and / or the contractor fails to show progress in execution of work and Uttarbanga Kshetriya Gramin Bank- Coochbehar Head Office feels the work cannot be completed within the stipulated time, Uttarbanga Kshetriya Gramin Bank- Coochbehar Head Office will have the right to terminate the contract by giving three days notice to the contractor, at the full discretion of Uttarbanga Kshetriya Gramin Bank- Coochbehar Head Office and the decision of Uttarbanga Kshetriya Gramin Bank- Coochbehar Head Office will be final and binding. In case of termination of the contract, the payment if any, due to the contractor will be released only on completion of the entire project. The amount that may be spent for completion of the balance work will be recovered from the contractor. It will be the full discretion of Uttarbanga Kshetriya Gramin Bank- Coochbehar Head Office to carry out the balance work through any agency at any rate as per the specification.

8. All the materials and workmanship shall be of the kind described in the schedule of quantities/ specifications and in accordance with relevant BIS codes and as per directions of the Engineer-in-charge.

9. The tenderers shall submit photocopies/ originals of vouchers/ challans etc., for verification of actual purchases of any material, if so, desired by the Engineer-in-charge.

10. The tenderer shall have to carry out testing of all materials brought on site at their own cost in any institute / laboratory / site of works as desired by the Engineer-in-charge. No extra claim will be entertained for such testing of materials.

11. The tenderer shall not at any time do, cause or permit any nuisance on the site/ do anything which shall cause unnecessary disturbances or inconvenience to the occupants / visitors at site or near the site of work.

12. The quantities indicated in the bill of quantities are approximate and the quantities may vary as per the site conditions / requirements. The rate quoted should be firm for the deviated quantities of work also.

13. The tenderer's workers will not be allowed to stay at the work site. However any deviation of the same is at the discretion of the Bank.

14. The tenderer or his workers can use the common facilities such as water, electricity etc., provided at the premises. However, it should be ensured that the same should be kept in hygienic condition.

15. Water and Electricity as per the availability at site can be made use of by the contractor. If not available the contractor has to arrange it on his own. However, the actual consumptions of water and electricity should be payable by the contractor only.

16. In case of any damage to the existing structure, the tenderer should rectify the same free of cost up to the satisfaction of the Authorized officer.
17. Uttarbanga Kshetriya Gramin Bank- Coochbehar Head Office will have the liberty to modify the design to a reasonable limit. No extra charges will be paid for execution after such modification.
18. The tenderer should protect the work till its completion and handing over against any possible damage, theft, scratches, etc.
19. The tenderer has to make arrangements for cleaning the work site every day and on completion of the work from the work area at his cost.
20. The tenderer should provide samples of the materials for approval of Uttarbanga Kshetriya Gramin Bank- Coochbehar Head Office the samples will be kept in the custody of the Engineer-in-charge.
21. Wherever possible the work has to be carried out at the factory of the contractor and the items to be transported to the site.
22. The tenderer should make necessary arrangement for inspection of the items made at his factory / work place by the Engineer-in-charge. The tenderer should complete fabrication and other works at factory and only assembling work and the finishing may be carried out at the site.
23. The tenderer should abide by the rules and regulations for the premises especially on the working hours, entry to the workers to the premises, interpersonal relation with the staff members and other agencies engaged at the site.
24. The tenderer should make necessary arrangement for covering of all the furniture items/ records, if any of the client with cover / cloth during the course of work.
25. Any damage / loss to Uttarbanga Kshetriya Gramin Bank- Coochbehar Head Office will be rectified at the cost & risk of the contractor.
26. The workmanship should be of high quality / standard and the decision of the Officer in Charge / Consultant shall be final in this regard.
27. The tenderer should not apply primer / putty work / paint or any other finishing material before inspection and certification of the wood work by the Officer in Charge.
28. The tenderer should strictly follow the approved color scheme. The color scheme will be intimated to the contractor within a week from the date of issue of the work order. However Uttarbanga Kshetriya Gramin Bank- Coochbehar Head Office has the liberty to make any other modifications as per requirements.

29. The tenderer shall ensure make his own arrangement for storage of materials. Uttarbanga Kshetriya Gramin Bank- Coochbehar Head Office or the client may provide some space subject to availability (uncovered) within the premises for storage purpose. Materials only as per requirement are to be stored at site. Security for the material lying at site will be arranged by the contractor.

30. Any damage / loss will be rectified at the cost & risk of the tenderer.

31. It is the responsibility of the contractor to get the confirmation certificate from the client after virtual completion of the work. The work will be considered as virtually completed only when the tenderer completes the entire work as per the specification and after joint inspection of work by the Engineer-in-charge and contractor.

32. No advance will be paid.

E. BILLS & PAYMENTS TERM AND CONDITIONS

1 (a) Billing is to be done in the name of the “Uttarbanga Kshetriya Gramin Bank, Head Office, Sunity Road, Coochbehar – 736101, West Bengal”.

1(b) The Contractor has to submit the bill strictly as per the format of the specifications as mentioned on the bill of quantities in the tender document.

NOTE: It is the responsibility of the contractor to take the no objection certificate / no defects certificate from the concerned client on completion of the Defect Liability Period. Uttarbanga Kshetriya Gramin Bank, Head Office - Coochbehar would not be responsible for the certificate.

2. Income Tax, TDS, Sales Tax on Work Contract, VAT, Cess and / or any other Statutory deductions as per the prevailing rules at the time of execution will be deducted from the payable amount for which certificate will be issued in favour of the tenderer.

3. Tenderer will not be entitled to any interest on Retention Money or Security Deposit or any Running account bill money for the time such money will remain with the Client.

4. The items of works as well as the approximate quantities against these items as given in the schedule of quantities and the same should not be considered precise quantity of works to be carried out. The tenderer shall be paid on the basis of the actual quantity of completed work as per the provisions of the contract and as per the specifications.

F. Escalation:

1. No escalation in rate shall be paid for the works carried out.

2. No claim on account of fluctuation of rates of material and labor will be entertained during the course of work – (from the date of acceptance of the tender till issue of completion certificate).

G. Defect Liability Period:

1. Defect Liability Period as per the terms of the contract is 12 months from the date of virtual completion of the work. The work will be considered as virtually completed only when the tenderer completes the entire work as per the specification and joint inspection of work by the Officer in Charge and tenderer.

2. The Security Deposit will be refunded only after the defect liability period of 12 months and rectification of the defects occurred whether pointed out in writing or not. It will be the duty of the contractor to inspect the site for defects and rectify the defects within the defect liability period.

3. During the course of Defect Liability Period the tenderer has to rectify all the defects,

4. In case the tenderer fails to attend the rectification work within 7 days of reporting the same in writing, Uttarbanga Kshetriya Gramin Bank, Head Office - Coochbehar will have the liberty to carry out the said work through some other contractor at the cost & risk of the tenderer. Such expenditure incurred to the client will be recovered from the Security Deposit. In case any expenditure incurred is more than the Security Deposit, the tenderer should pay the difference that may fall short.

5. While carrying out the rectification work, the tenderer should ensure that the surroundings should be protected against any possible damage. In case of any damage, the same should be made good by the tenderer.

H Statutory obligations to be followed:

1. The tenderer should ensure adherence of all statutory requirements under the State and Central Rules in force and other local bodies for smooth and timely completion without any additional cost.

2. The tenderer shall comply with the provisions of all the rules and regulation in respect of labors engaged at site for execution of work, procurement of material for completion of the entire project. Uttarbanga Kshetriya Gramin Bank, Head Office - Coochbehar shall not be held responsible for any penalty on failure to comply with any of the labor regulations or legal requirements or failure of any compliance of any rule in force.

3. The tenderer shall strictly comply with the provision of Sales Tax (both State & Central), Excise Duty, etc. All the duties / taxes with respect to the work should be borne and paid by the tenderer himself Uttarbanga Kshetriya Gramin Bank, Head Office - Coochbehar shall not be responsible for any payment/ penalty on this account at any stage.

4. In case any goods are manufactured at the tenderers office / site, the tenderer has to pay Central Excise and he has to produce Excise Invoice Copy for removal of goods from the manufacturing site. In case the goods are manufactured or produced at the site then Excise Invoice showing that the Central Excise has been paid should be submitted to Uttarbanga Kshetriya Gramin Bank, Head Office - Coochbehar
5. The tenderer should submit a statement confirming that all duties / taxes of every nature covered under the contract have been paid and the tenderer shall indemnify the Uttarbanga Kshetriya Gramin Bank, Head Office - Coochbehar against all claims in that behalf.
6. The tenderer should ensure adherence of all the requirements and statutes under the State and Central Rules in force.
7. The tenderers should submit an affidavit / Declaration for payment of Central Excise as per the enclosed format.
8. The tenderer should also submit when required, a copy of the declaration filed with the Central Excise for the last financial year.

Responsibilities of the tenderer

1. The tenderer should enter into an agreement as per the articles of agreement on stamp paper attached with this notice within 7 days of issue of acceptance of the tender.
2. The tenderer shall not sublet the work without written approval from Uttarbanga Kshetriya Gramin Bank, Head Office - Coochbehar.
3. The tenderer should co-ordinate with all the other contractors if any for execution of the project.
4. The tenderer should set out the layout at site before commencement of work and obtain approval for the same from Uttarbanga Kshetriya Gramin Bank, Head Office - Coochbehar
5. The contractor should arrange for sufficient light & power point required for entire project at his cost.
6. The tenderer should clear the site within 7 days of virtual completion of work of all material not paid for. The work will be considered as virtually completed only when the tenderer completes the entire work as per the specification and after joint inspection of work by the officer in charge and tenderer.
7. The tenderer should submit the schedule and bar chart of work before commencement of the work at the behest of the Uttarbanga Kshetriya Gramin Bank, Head Office - Coochbehar.

8. The tenderer should take adequate precaution against fire hazards at the site. The tenderer should ensure that all fire safety measures are taken during execution and that the work carried out is as per the fire safety norms of the local fire office
9. The tenderer should arrange for scaffoldings/ladder for proper execution of work and shall also ensure safety of the workers as per the relevant provisions of the law
10. The tenderer should keep samples of the materials used at the site and should be able to produce the same to the Uttarbanga Kshetriya Gramin Bank, Head Office - Coochbehar if desired.
11. In case the tenderer is a partnership firm, any change in the constitution of the firm shall take place only with the prior approval of the Uttarbanga Kshetriya Gramin Bank, Head Office - Coochbehar during the contract period.
12. The tenderer submit shop drawings of all the items for the approval of the Uttarbanga Kshetriya Gramin Bank, Head Office - Coochbehar before execution of each item of work.

Uttarbanga Kshetriya Gramin Bank, Head Office, Sunity Road, Coochbehar – 736101,
West Bengal

SUMMARY	
Time of Completion	30 days from the date of commencement of work
Date of Commencement of work	Within 7 days from the date of issue of work order.
Liquidated damages	0.5 % of the total final certified value per day subject to the maximum of 10 % of the final certified value.
Validity of the offer	60 days from the date of opening the tender.
Security Deposit (Retention money)	10 % of total value of work done, out of which, 50% will be released at the time of settlement of final bill.
Defects Liability Period	12 (Twelve) months from the date of virtual completion / handing over
Terms of Payment	<ol style="list-style-type: none"> 1. No advance 2. Final Bill settlement within 30 days from the date of proper submission of all required documents and joint verification of measurements at site. 3. Running bills can be raised and it shall be at the discretion of the bank
Deductions	<ol style="list-style-type: none"> 1. Income Tax at source as per Income Tax Rules Sales Tax / Works Contract Tax/ Commercial Tax as applicable in the statement. 2. Cess applicable as per the local rules 3. Any other Levy/Cess/Tax to be deducted at source by law.

I / We hereby agree and accept the above terms and conditions.

(Seal) Signature of the Tenderer

For (Name and address of the Contractor)

For (Name of the Contractor and Designation)

Special Conditions of the Contract

1. The wood to be used should be of teak wood beadings. The beadings to be fixed with adhesive/screws/nails.
2. All the edges of the plywood should be teak wood beadings. The beadings to be fixed with adhesive/screws/nails.
3. The measurements indicated in the drawings are approximate and may vary as per the site conditions. In case of any changes in the drawing after the tender or execution of the drawing, at behest of the local branch authorities, engineer in charge, the alteration of the quantities shall be paid on actual measurements as per the tender rates. Execution of work non similar to the tender shall be paid on actual + 15% as applicable.
4. The contractor shall submit the Bar Chart & Pert Chart before commencement of the Work at the behest of the Bank.
5. For the design and other details mentioned in the entire documents Uttarbanga Kshetriya Gramin Bank, Head Office - Coochbehar have the patent rights.
6. The contractors shall take the prior approval from Uttarbanga Kshetriya Gramin Bank, Head Office - Coochbehar for subletting the job even is the same is specialized agency
7. In case Uttarbanga Kshetriya Gramin Bank, Head Office - Coochbehar rejects a particular work the tenderer shall remove the same within two days and no payment shall be made for such work.
8. The contractors has to take all safety measures with regard to the workmen employed as per relevant laws and good engineering practices at site and safety measures against the fire hazards.
9. The Contractors has to make necessary arrangements for internal lightening at the site.
10. The Contractor has to carry out the job strictly as per the specifications spelt out in the bill of quantities, drawings, instructions that may be issued by the engineers in charge and the specifications of the Bureau of Indian Standards, National Building Code etc.
11. In case of any discrepancy between the specifications and the drawings, the details mentioned in the specification/Bill of quantities may be taken as final.
12. The contractor shall submit the single line drawing of electrical installations/wirings to completed work along with the final bill.
13. The contractor shall submit the test certificate of the electrical installation carried out by him as per requirements of local electrical supply authority, Indian Electrical Rules and Indian Electricity Act.

14. The work shall be carried out on holidays and Sundays after and before office hours and during office hours on working days. The contractor shall ensure that there shall not be any problem disturbance in office/ other areas/ floors as the work is to be executed in working office.
15. The contractor shall depute one electrician and one helper during office hours to avoid any electrical breakdown in electrical instillation.
16. **The work can be awarded to the agency that has given the lowest rates (L-1). However the same is not binding to the Uttarbanga Kshetriya Gramin Bank, Head Office - Coochbehar and the final decision shall be at its discretion. The decision of the Uttarbanga Kshetriya Gramin Bank, Head Office - Coochbehar in the matter shall be final without appeal and it is not binding on the bank to assign any reason for the same.**
17. **There on the L2 Bidder will be asked to confirm if he can do the work at the lowest rate quoted by L1.**
18. **If L2 gives a consent letter confirming that he is ready to carry out the work at the lowest rate (L1) then it can be considered to award the work to him also. The condition of this award of work to L2 on the rates of L1 will be as under.**
 - A) **When L1 denies in writing that he does not have capacity to do the work**
 - B) **When it is observed by Uttarbanga Kshetriya Gramin Bank, Head Office - Coochbehar that L1 has not completed more than 3 sites on time**
 - C) **When defects are found in the work of L1**
 - D) **When L1 does not take up the as assigned work within the stipulated time period as mentioned in the work order**
 - E) **Any other disparity or inconsistency is found by the Uttarbanga Kshetriya Gramin Bank, Head Office - Coochbehar with LI or the bank is not convinced with quality and sustainability.**

PREAMBLE OF THE BILL OF QUANTITIES

The work proposed is to be carried out at the office premises mentioned here in. The premises are proposed to be provided with furnishing, civil, and plumbing works. The quality of work proposed should have the best workmanship. The contractor should ensure that only the first quality materials mentioned in the list of materials is purchased for the project.

The work should be carried out in such a way that the structure is not disturbed.

Any differences/ dispensaries in the specifications should be clarified with the Authorized Officer/ Uttarbanga Kshetriya Gramin Bank, Head Office - Coochbehar before submitting the tender. The Uttarbanga Kshetriya Gramin Bank, Head Office – Coochbehar shall be at liberty to

modify the specification to a reasonable limit to suit the basic concept during the course of work: the tenderer should carry out such work without any extra cost.

In case of any major modifications such items will be considered as extra items. Payment for such items will be paid based in the interpretation of the engineering rate/ market rate analysis. 15% of the total cost of material and labor will be considered as tenderer profit.

The contractor should co-ordinate with the other contractors employed at the site for smooth flow of work.

List of approved materials for Civil, Interior & Furniture works		
1	False Ceiling- 1)Gypsum Board 2)Armstrong Tiles	1) 12.5mm thick Gypsum Board of Gypsum India Ltd. with sections of 26 gauge GI sheet of "Gypsum India Ltd." Company 2) Armstrong 600x600x(12-15 mm thick) perforated tiles as per "Armstrong Pvt. Ltd." company's specifications
2	Aluminum Sections 1.Partition 2.Door	16-18 Gauge anodized Aluminum tubular sections with 20 micron (black) of 50x50mm, 50x40mm for partition and 16-18 gauge anodized Aluminum sections of 40x115mm for bottom rail & top rails of doors, 40x150mm lock rail and 40x20mm plain for shutters of the sliding window. All aluminum section to be anodized in black shade and shall be of "Jindal/Nalco/ Hindalco".
3	Aluminum Grill	Aluminum grill of 8- 10 mm dia. rod with 75x75mm mesh DG 202 of "Jindal/Nalco/Hindalco"
4	MDF/Particle Board	12 mm thick both side laminated "Novapan/Greenlam/Archidlam/Century" with Ivory/ Beige shade BSL, Interior grade IS: 12823.
5	1.Plywood/Block Board (BWP/BWR) 2.Plywood/Block Board	1) Phenol bonded, water proof, plywood of all required thickness (6mm,9mm,12mm,19mm and 25mm) of "Century, Duro, Green, Anchor, Archid, Prince, Samrat" conforming to IS: 303, IS: 710 & IS:1659 2) MRIS: 303.
6	Wood	Well-seasoned teak-wood
7	Moulding& Lipping	1 st Quality Teak Wood .
8	Wood Preservative	"ASIAN/ NEROLAC/ BERGER/ICI/ DULUX"
9	Adhesive	"FEVICOL(SH)/ PIDILITE"
10	Glass	Plain float glass "Modi/ Saint Gobain /Ashai" of all thickness.
11	Lock/Night Latches	"GODREJ(LKYLDM433 (MRP 1540/-) (LKYLDN703 (MRP 850)/DORSET/LINK/HARRISON"
12	Hydraulic Door closer	"HYPER, AMAR, SAMRAT, GODREJ(LKYGD2000 (MRP 1700/-), EVERITE, ALLWIN, GARNISH" confirming to IS:3564:1986.
13	Floor Spring (Double action 100 kg. -150 kg)	"HEMCO, GEZE, DORMA, OZONE" confirming to IS: 6315:1992 & IS:7197:1972.
14	Drawer Channel/Slider (Telescopic)	Sleek computer keyboard slide of required length mounting telescopic, steel ball slider STDS series keyboard of "EARL BIHARI, EBCO, HETTICH, SOLO, GODREJ".
15	Key Board Drawer/Tray	Ready to use, computer keyboard tray KBT series keyboard of "EARL BIHARI , EBCO, HETTICH, SOLO, GODREJ".

16	Hard ware	All the necessary hardware shall be of ISI marked with best quality/ and as per Bank's approval.
17	Teak wood	Beading and Moulding to be of first quality teak wood.
18	Paint Off white, Desert White, Cream	1.Acrylic paint/ Luster Paint:- "ROYALE, ICI, ASIAN DULUX/NEROLAC". 2.Oil bound distemper:-"ROYALE, ICI, ASIAN DULUX/NEROLAC". 3. Synthetic Enamel Paint:- "ROYALE, ICI, ASIAN DULUX/NEROLAC". 4. Texture Paint:- "WEATHER COAT, EXTERIOR, APEX, SNOCEM, ASIAN" Exterior Crusade 0684.
19	Flooring (Off white)	1)Vitrified tiles: - 600x600x (8-10 mm thick) Premium Range "NAVEEN/ NITCO/ ASIAN/ SOMANY/ MARBONITE/ KAJARIA/ JOHNSON". 2)Ceramic Tiles:-"NAVEEN/NITCO/ASIAN/SOMANY/ MARBONITE/ KAJARIA/ JOHNSON". 3)Vinyl Flooring:- 2mm thick "Royale, LG, ASIAN KRISHNA, ARMSTRONG".
20	Roller /Venetian Blinds (Off white, Abstract Biege B/O-0002	"VISTA, MAC, AUROLUX".
21	Chairs with fabric Red and Blue as per Bank's standardization	"GODREJ, METHODEX, , FEATHERLITE, DURIAN, WIPRO, AMARDEEP" (High, Mid, Low back and visitors chairs).
22	Visitors Seating	Chrome plated Perforated seats 3seater and 2seater.
23	Rubber/ Polyurethane /Tapestry/Leather Foam	Foam of all thickness of 40-50 density HD U- Foam of "Dunlop, MM, TATA, PUJA".
24	Wash Basin	Vitreous China, conforming to IS: 2556 "Hindware/Cera/Johnson/Parryware".
25	WC(EWC/Orissa Pan)	Vitreous china, conforming to IS:2556 "HINDWARE/CERA/JOHNSON/PARRYWARE".
26	GI Pipes	"C"- Class GI pipes, for all the diameters, "JINDAL, BINDAL, TATA".
27	Tap & Flush cock	CP Finish bib cock and pillar cock, flush cock. "PLUMBER, JENITH, JAL, JAGUAR, MAC,BELL".
28	Sink	Stainless steel sink. "NIRALI".
29	Cement	Best quality, 53 Grade (OPC)- "ACC, AMBUJA, BINANI, BIRLA confirming to IS:1489-1976.

30	Steel	Hot rolled deformed bars confirming to IS:1139-1966 (Fe-415 HYSD) "TATA, Jindal, Rathi SAIL, RINL".
31	Aggregates	Aggregates shall comply with the requirements of IS:383-1970.
32	Brick Works	All brick work shall confirm to IS:2212-1962.
33	Reinforcement Bending and Fixing Works	Bending and fixing of bars for concrete works shall be as per IS:2502-2009.
34	RCC/PCC Works	All RCC/PCC works shall confirm to IS:456-2000.
35	Aluminum Composite Panel	"Alstone/ Alucobond/Eurobond".
36	Modular Work Stations	"Godrej, Methodex, Wipro, ShapoorjiPaloonji, Featherlite".
37	Laminates 1.0 mm thickness	<p>Figured maple - 525(Century Mica) - IVORY/OFF WHITE Figured walnut - 951(Century Mica) - BROWN Radiant Red – 191(Century Mica) - RED(Skirting-1") Blue – 245 (Century Mica) - BLUE(Skirting-3")</p> <p>Sugar Maple - 1758 (Formica Mica) - IVORY/OFF WHITE Vintage Teak – 1713 (Formica Mica) - BROWN Cardinal Red – 1576 (Formica Mica) - RED(Skirting-1") Electric Blue – 1568 (Formica Mica) - BLUE(Skirting-3")</p>

- Tenderer shall use all the materials strictly as per the list of approved make as stated above. It is mandatory to take written confirmation well in advance if the materials as stated above is not available and /or the same is not suitable (Color, Size Shape, Texture) as per the conditions.
- In case the tenderer wish to verify the detailed specifications of materials workmanship etc, the same may be verified from the office of bank consultant before submission of Tender.
- Whether a product is equivalent or not shall be decided by the Authorised personnel /Architect Only.

PRICE BID
FOR
INTERIOR & FURNISHING WORK
OF
RATHKHOLA BRANCH OF
UTTARBANGA KSHETRIYA GRAMIN BANK

UTTARBANGA KSHETRIYA GRAMIN BANK

(Sponsored by Central Bank of India)

Head Office : Sunity Road

Coochbehar : 736101 (West Bengal)

Uttarbanga Kshetriya Gramin Bank, Rathkhola Branch

Serial no	Section	Description	Amount
I	SCH-INT	Interior work	
II	SCH-FUR	Furniture work	

TOTAL OF WORK

UTTARBANGA KSHETRIYA GRAMIN BANK,RATHKHOLA BRANCH					
SECTION - I					
INTERIOR WORK					
SL. NO	ITEM DESCRIPTION	UNIT	QTY.	RATE	AMOUNT
				(Rs.)	(Rs.)
1	<p>Providing and fixing 5' high Partly Glazed Low Height double skin partition with Decorative Etching(as per detail drawing) with the following specifications: Frame Work vertical member - (50×50) mm 900 mm c/c at the corner at the door opening the size should be of (50×50) mm Horizontal member - (50×50) mm 4 number or as per the site condition. Both sides of the frame work fixed with 6 mm BWR ply with laminate of approved make and shade up to height of 900 mm and the remaining portion 12 mm glass with slit of 50 mm or as per direction of the Architect. All the posts are to be polished with natural sprit polish and the top finished will decorative cap etc. The detail of counter partition as per drawing enclosed.(For Manager Room,ups & Server Room,officer,clerk,passage & S.w.o)</p>	Sqft	370		
2	<p>Supplying and erecting Full Height partly glazed partitions (upto False ceiling height) as per drawing and conforming to the following specifications: basic frame work Well seasoned malaysian sal wood sections, treated with two coats of wood preservatives, 60 mm wide x 40 mm (minimum) at maximum 700mm horizontal or vertical spacings as per site conditions. Vertical members shall suitably with extended upto, anchored and cross-tied at ceiling level. Exposed frame members in the glazed portions shall have wider spacings (max. 1800 mm. clear)as per instructions. Exposed members shall be finished with 1.00 mm thick laminate sheet of same or combination shades, over 6 mm BWR grade plywood facing including 1x1 mm grooves at locations as per instruction. There will be provision for small trays windows for transferring of small copy either from the banking area to the cash cabins or between the cash cabins as directed by te architect. skin membrane :(opaque portion upto 900 mm from floor level and from 2100 mm to 2550 mm from floor level with 6 thick BWR grade plywood on each face, providing 1 x 1 mm. grooves formed at the top layer as per drawings/instructions.</p>				

	skirting 100 mm high x 12 mm thick polished 1st class teak wood skirting on both faces, with NC lacquer in mat finish. Glazing: 6 mm thick clear float glass with glass in two pieces etching 1.5" strips by 1.5" gap fixed with continuous 1st class Teak wood beads of approved shape (finished 35 x 25 mm) all round, polished and coated with melamine lacquer finish.				
	Quoted rates shall include all necessary materials, accessories and labour and also allow provisions for electrical / telephone / computer wiring conduits and switch boxes, etc (Materials for wiring conduits and switch boxes shall be separately paid for). (For cash & side of S.W.O)	Sqft	250		
3	Supplying and erecting Full Height opaque partitions (upto ceiling false ceiling height) as per drawing and conforming to the following specifications : basic frame work : well seasoned Malaysian sal wood sections, treated with two coats of wood preservatives, 60 mm wide x 40 mm (minimum) at maximum 600mm horizontal or vertical spacings as per site conditions. Vertical members shall be suitably anchored at ceiling level to ensure rigidity. skin membrane : 6 mm thick BWR grade plywood with 1.0 mm thick laminate sheet of same or combination shades as per instructions. skirting : 100 mm high skirting finished with 1mm thick laminate of approved shade & texture on both faces , Quoted rates shall include all necessary materials , accessories and labour and also allow provisions for electrical/telephone/computer wiring conduits and switch boxes, etc (Materials for wiring conduits and switch boxes shall be separately paid for).				
	Quoted rates shall include all necessary materials, accessories and labour and also allow provisions for electrical / telephone / computer wiring conduits and switch boxes, etc (Materials for wiring conduits and switch boxes shall be separately paid for). (For Record.safe,pantry,pantry passage & main door)	Sqft	370		

4	<p>Providing and erecting in position Cash Work Station for Full height Cash Counters comprising of clerical workstation of approx.size 1500(l) x 900(b) x 750(h) mm inclusive of a 1015 mm high, 300 mm wide customer writing top finished with granite with edge moulded of approved shade and quality, fixed with chemical adhesive; exposed surfaces of block board are to be provided with 6 mm thick polished 1 st class Teak wood lipping.The workstations shall be supported from the partition system and made of 19 mm thick BWR garde block board finished with 1.00 mm thick laminate sheet including inner faces. Free edges shall have 1 st class Teak wood mouldings of half-round profile as per drawings and instructions.</p>				
	<p>The drawers and corresponding area of modesty panel (front facia) are to be cladded with 14 S.W.G M.S sheet, painted with two coats of synthetic enamel paint of approved shade and brand over a coat of approved steel primer. Each cash work station shall comprise of the following: Drawer unit having readymade stationery drawer of engineering plastic Tea tray at top.</p>				
	<p>Cash drawers with approved telescopic channels for drawer - slides, automatic locks (keys in duplicate) and other necceary hardware and accssories including satin finish S.S handles of approved quality.</p>				
	<p>Readymade key board tray of powder coated steel with mouth tray (KBT - 45 of Ebco or approved) and all necessary accessories, suitably suspended below table top; CPU trolley of Readymade Ebco make below drawer unit including provission for wire manager on work top at specified location.</p>	Rft	5		

5	<p>Single window counter with Decorative Etching (as per detail drawing overall size 1500 mm × 800 mm × 1500 mm) supply and fixing of ledger counter in position made of 19 mm thick block board work top 800 mm wide at 750 mm from finish floor level and 300 mm wide customer top at 950 mm level. Both top finish with 1.0 mm laminate of approved shade over block board (the detail of counter as per the drawing enclosed). The skirting should be of 100 mm × 12 mm timber Vertical part finish with 1.0 mm thick laminate. All visible veneer and timber surface finish with nature spirit polish. Provide 100 mm × 12 mm wooden skirting at bottom and provided 12 mm thick float glass keeping 50 mm gap above transaction top fitted with 35 mm × 20 mm wooden bead. All complete as per direction and as per the detail drawing enclosed. The drawers should be provided with automatic locking arrangement as per the requirement of the Bank. the drawers key board tray etc. are to be provided with decorative brass knobs, handle etc. and should be provided with wire management system & foot rest, Magnetic Catcher to provided.</p>	Rft	10		
6	<p>Supplying & fixing in position 37 mm. thk solid core hot pressed phenol formaldehyde bonded BWR grade partly glazed flush door shutter (size of shutter = 2' x 7' & 3' x 7') of approved make finished upto 900 mm with 1.0 mm thick laminate sheet of approved quality on both sides of the door shutter. The upper portion of the shutter is to be provided with 6 mm thick clear float glass fixed with rubber wood glazing beads of approved design, complete as per drawing. Rate to include cost of hardware fittings e.g. handle locks, aldrip handles, door closer & night latch all of approved make as by the Architect. The exposed timber surfaces are to be polished in approved colour and finishing the same with N.C. lacquer in mat satin finish. (For Passage, cash)</p>	Sqft	60		
7	<p>Supplying & fixing in position 37 mm. thk. solid core hot pressed phenol formaldehyde bonded BWR grade Laminated Flush Door Shutter (size of shutter=3' x 7') finished with 1.0 mm thick laminate sheet of approved shade and quality on both sides of the door shutter including cost of hardware fittings e.g lock, brass hinges etc. of approved make and quality. (For Pantry, passage, Safe & Record)</p>	Sqft	85		

8	Supply fitting and fixing in position Swing Door 5' high with Decorative Etching (as per detail drawing) with the following specifications: Vertical members - 2 numbers (75×35) mm size Horizontal Members 0-4 numbers (75×35) mm size Both sides of the frame work should be covered with 6 mm BWR grade ply with 1.00 mm laminate with locking arrangement, door stopper door closer etc. all the hardware fittings should be ISI mark. The door to be matched with the adjacent decor with 6 mm glass. At the bottom of the door, opening of size (250 × 150 mm) to be fix with ornamental aluminum grill with all sides beading etc. complete. Night latch to be provided. (FOR back side of officer & clerk,passage,server,ups room manager room)	Sqft	90		
9	Providing and erecting in position Storage Cabinet made of 19 mm thick BWR grade blockboard as per drawing including intermediate shelves, locable shutter etc.confirming to the following specification : shutter faces shall finished with 1mm thick laminated sheet of same or combination shades as per instruction with polished 1 st class Teak Wood(6mm thick) edge lipping. Inner faces of shutters shall be finished with 1mm thick white laminate sheet. Shutters will be hung by auto-closing hinges of "Ebco" or equivalent. Locks, handles etc. will be approved variety & make. Inner surfaces of cabinet finished with 2 coats of synthetic enamel paint over a coat of approved primer.(Payment shall be on the on the area of cabinet face). (For back side of clerk,officer 3 & manager room)				
	A)Low Height=Maximum 450 mm wide x 750 mm high .	Sqft	55		
10	Supplying, providing & fixing suspended Plain False Ceiling (as per detail drawing) with Gyp Board including G.I. Channel frame work as per manufacturer's specifications and design. The boards to be joined with jointing compound, papers tape and then two coats of primer, suitable for Gyp Board (as per recommended particles of Indian Gypsum Ltd.) including acrylic emulsion paint (2 coats) of approved shade and quality one coat of primer with all labour of materials complete (AS PER DRAWING).	Sqft	1265		

11	Supply & Fitiing ARMSTRONG PANEL for Grid False Ceiling (Armstrong Mineral Fibre Acoustical Suspended Ceiling System with 16 mm thk Dune (Bevelled Tegular) Edge Tiles With Armstrong 15mm Exposed GRID) gypsteel BPB grid (600mm) suspended ceiling grid system with hod dipped precoated galvanised steel T section (main runner , cross t, wall angle)with Approved design - make panel semi perforated panel work with provision for light fixtures including necessary accessories includes finishing painting with white emulsion paint. (AS PER DRAWING).Simillir approved make of Gypboard.	Sqft	240		
12	Providing & fixing in position 4" high P.O.P Cornice among the edge of the walls with the False ceiling.	Rft	205		
13	Column Encasing (upto False ceiling height) works as per drawing and conforming to the following specifications basic frame work : well seasoned Malayasian sal wood sections, treated with two coats of wood preservatives, minimum 50 x 25 mm, at suitable horizontal/ vertical spacings not exceeding 600 mm clear. skin membrane : 6 mm thick BWR grade plywood finished with 1mm thick laminate of approved shade and texture to be pasted on plywood surface with suitable chemical adhesive, provide 1x1mm grooves, all complete as per instructions. skirting :100 mm high skirting finishd with 1mm thick laminate of approved shade & texture.Quoted rates shall include all necessary materials, accessories and labour and also allow provisions for electrical / Telephonic / Computer wiring conduits and switch boxes, etc complete with necessary jacking/thickening of panels to accommodate conduits/switch boxes. (Materials for wiring conduits and switch boxes shall be separately paid for.) (For exposed columns As per Drawing)	Sqft	390		
14	Providing & fixing in position FULLY GLAZED DOOR FOR MAIN ENTRY made of approved round edge anodised aluminium top and bottom style fixed in position with 12 mm thk. toughened glass with necessary hardware fixture of approved make and design, eg. double action ISI mark floor spring on which the shutters are pivoted at the top and bottom, brass flush bolt, brass hinges,brass tower bolt,satin finish stainless steel decorative tubular handles on both the faces, (Dorset or equivalent approx. 300mm long) complete as per direction. (Two Panels,Each of size 675 mmx 2100 mm)	Sqft	28		
15	Providing & fixing Vertical Blinds of approved make & Colour.	Sqft	275		

16	<p>Providing and erecting in position Cabinet for Electrical Main Panel made of 19 mm thick BWR grade blockboard as per drawing including intermediate shelves, locable shutter etc.confirming to the following specification : shutter faces shall finished with 1mm thick laminated sheet of same or combination shades as per instruction with polished 1 st class Teak Wood(6mmthick) edge lipping. Inner faces of shutters shall be finished with 1mm thick white laminate sheet. Shutters will be hung by auto-closing hinges of "Ebco" or equivalent. Locks, handles etc. will be approved variety & make. Inner surfaces of cabinet finished with 2 coats of synthetic enamel paint over a coat of approved primer.(Payment shall be on the on the area of cabinet face) (Size of 3'- 4" x 7')</p>	Sqft	63		
17	<p>Providing & fixing trap doors consisting of 1/4" thk.BWR grade ply shutters with a clear opening of 4.5" opening for smooth operation of shutters and rest is closed with mirror screws(for opening for servicing).The shutters shall be finished with approved 1.0mm thk.Wenge laminate, frame of 2" x 1 1/2" teak wood section shall be provided for proper support and strength.Rate shall be inclusive for necessary fittings like hinges(Ebco make),ball catchers,tower bolts etc.(BOXING FOR ROLLING SHUTTER)</p>	Sqft	80		
TOTAL				RS	

UTTARBANGA KSHETRIYA GRAMIN BANK,RATHKHOLA BRANCH					
SECTION - II					
FURNITURE WORK					
SL	ITEM DESCRIPTION	UNIT	QTY	RATE	AMOUNT
NO.				(Rs.)	(Rs.)
1	<p>Providing and erecting in position,Free-Standing Table as per drawing and conforming to the following specifications: basic structure of 19 mm thick BWR grade block board for sides, top and modesty panel, finished with 1.00 mm thick laminate sheet of approved shade and make including inner faces. drawer-cum-cabinet unit of approximate overall size of 400 x 500 x 700 mm (w x d x h) of 19 mm thick BWR grade block board and 12/6 mm thick BWR grade plywood. The drawer unit shall comprise of two drawers and one cabinet with inner faces polished in approved shade. The drawer unit shall be finished with 1.00 mm thick laminate sheet of approved shade including inner faces of cabinet shutters,finished plywood keyboard tray and all necessary accessories ,suitably suspended below table top,CPU trolley of readymade Ebco make, provision for wire manager on table top at specified location.</p>				
	<p>For the purpose of customer transaction the counter has 12mm thick clear float glass and 250mm high etched glazing placed 100mm away for customer side and 50mm above the customer top thus making a total height of 450 mm and 150mm x150 mm plywood box placed at the front side of banking counter as per detail drawing.(No need for Manager's Table)</p>				
	<p>Quoted rates shall also include cost of polished 1 st class Teak wood moulding (out of min. 40x20 mm section) to edges of table top; polished 1 st class Teak wood lipping (6mm thick) to free edges of block board plywood surfaces; approved drawer-slides , concealed type auto - closing shutter hinges and locks with keys in duplicate; other necessary hardware and accessories including handles, knobs, etc. of approved quality.</p>				

i)	Approx. size of 1800x750x750mm (FOR MANAGER.)	Each	1		
ii)	Approx. size of 1500x750x750mm (FOR OFFICER 1,2 & 3)	Each	3		
2	Providing and erecting Side cabinet unit is of size 900 mm length, 450 mm deep & 750 mm high consisting of a 375 mm length of a side unit 3 sets of drawer i) top row of 100mm high drawers ii) 150 mm high drawer at middle & iii) 350 mm high drawer at bottom and 525 mm length cabinets with openable shutters, all finished in 1mm thk. Laminate. (FOR MANAGER, OFFICER 1 & 2.)	Rft	9		
3	Supplying and erecting Running table 450 mm wide and 750mm high for Server Room including drawer-cum- cabinet unit for files, space for CPU or computer, modesty panel, tea tray etc. made with 19 mm thick phenol formaldehyde bonded block board on top and supporting sides with necessary well seasoned Malaysian sal wood frame work, finished on top and sides with 1.0 mm thick laminate of approved shade and quality, supported on well seasoned Malaysian sal wood frame work including providing and fixing three 450 mm long powder coated steel key board tray (with mouse tray) of approved shade (Model No. KBT45 of MIs. Earl Behari Pvt. LTd. or similar approved make) having sliding channels at the two sides of the keyboard. The keyboard is to be suspended from the table top, all complete as in drawing. All exposed edges of block board are to be provided with 1st class Teak wood mouldings, duly polished. Inner faces of wooden block board surfaces are to be finished with minimum two coats of synthetic enamel paint of approved shade and quality over a coat of approved primer.				
	Rate to include charges for brass hardware fittings as well as fixtures like sliding gear for drawers of "Ebco" or similar approved make.	Rft	6.00		

4	<p>Supplying and erecting Rectangular work station unit (CLERK) of approx. size 1200 mm x 750 mm x 750 mm inclusive of 975 mm high, 175 mm wide projection made of 19 mm thick phenol formaldehyde bonded block board finished with 1 mm thick laminate sheet of approved shade and quality supported on low height partition, complete as per drawing and conforming to the following specifications :</p> <p>drawer-cum-cabinet unit of approximate overall size of 400 x 500 x 700 mm (w x d x h) of 19 mm thick BWR grade block board and 12/6 mm thick BWR grade plywood. The drawer unit shall comprise of two drawers with inner faces polished in approved shade. The drawer unit shall be finished with 1.00 mm thick laminate sheet of approved shade including inner faces of cabinet shutters. readymade keyboard tray of powder coated steel with mouse tray (KBT45 of Ebco or equivalent) and all necessary accessories, suitably suspended below table top; For the purpose of customer transaction the counter has 12mm thick toughned glass and 250mm high etched glazing placed 100mm away for customer side and 50mm above the customer top thus making a total height of 1200 mm and 150mm x 150 mm plywood box placed at the front side of banking counter as per detail drawing.</p>				
	<p>Ebco CPU trolley below drawer unit including provision for wire manager on work top at specified location. The front of the cash counters shall have 12 mm thick & approx. 300 mm high toughned glass in two pieces at sides with polished 1st class Teak wood glazing beads.</p>				
	<p>Quoted rates shall also include cost of polished 1st class Teak wood moulding (out of min. 40x20 mm section) to edges of table top; polished 1st class Teak wood lipping (6mm thick) to free edges of block board plywood surfaces; approved drawer-slides, concealed type auto - closing shutter hinges and locks with keys in duplicate; other necessary hardware and accessories including handles, knobs, etc. of approved quality.</p>				
	<p>approx. size 1200 mm x 750 mm x 750 mm (FOR CLERK)</p>	Each	1		

5	Supplying and erecting wall mounted Customers' Writing top-As per layout drawing made of 19 mm thick BWR grade block board . Box type top of 12mm th. glass exposed block board top and side are to be finished with 1.0 mm thick laminate sheet of approved shade and quality with three partition for four compartment. Exposed free edges of block board are to be provided with 6 mm thick polished teak wood lipping.Size 2'x1' edges round.	nos	1		
	Total			RS	

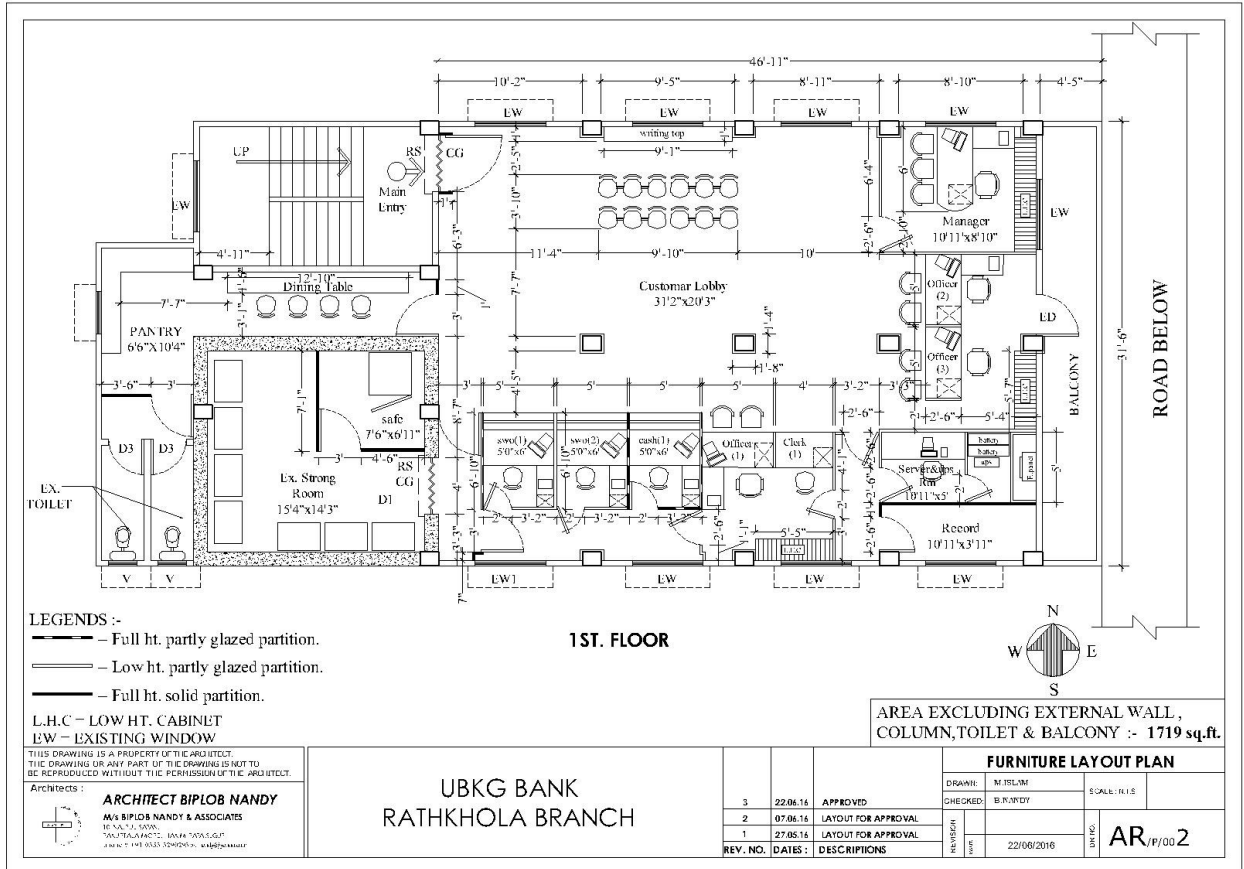

- LEGENDS :-**
- Full ht. partly glazed partition.
 - Low ht. partly glazed partition.
 - Full ht. solid partition.

L.H.C - LOW HT. CABINET
 EW - EXISTING WINDOW

THIS DRAWING IS A PROPERTY OF THE ARCHITECT.
 THE DRAWING OR ANY PART OF THE DRAWING IS NOT TO
 BE REPRODUCED WITHOUT THE PERMISSION OF THE ARCHITECT.

Architects : **ARCHITECT BIPOLO NANDY**
 BIPOLO NANDY & ASSOCIATES
 BE SALT LAKE, UTAH
 "SALTY ARCHITECTURE" - BE SALT LAKE, UTAH
PHONE: 1-801-552-2000 FAX: 1-801-552-2001

**UBKG BANK
 RATHKHOLA BRANCH**

AREA EXCLUDING EXTERNAL WALL,
 COLUMN, TOILET & BALCONY :- 1719 sq.ft.

FURNITURE LAYOUT PLAN	
DRAWN: M. ISLAM	SCALE: 1/8" = 1'-0"
CHECKED: B. R. NANDY	
DATE: 22/06/2016	NO: AR/P/002

REV. NO.	DATE	DESCRIPTION
3	22.06.16	APPROVED
2	07.06.16	LAYOUT FOR APPROVAL
1	27.05.16	LAYOUT FOR APPROVAL

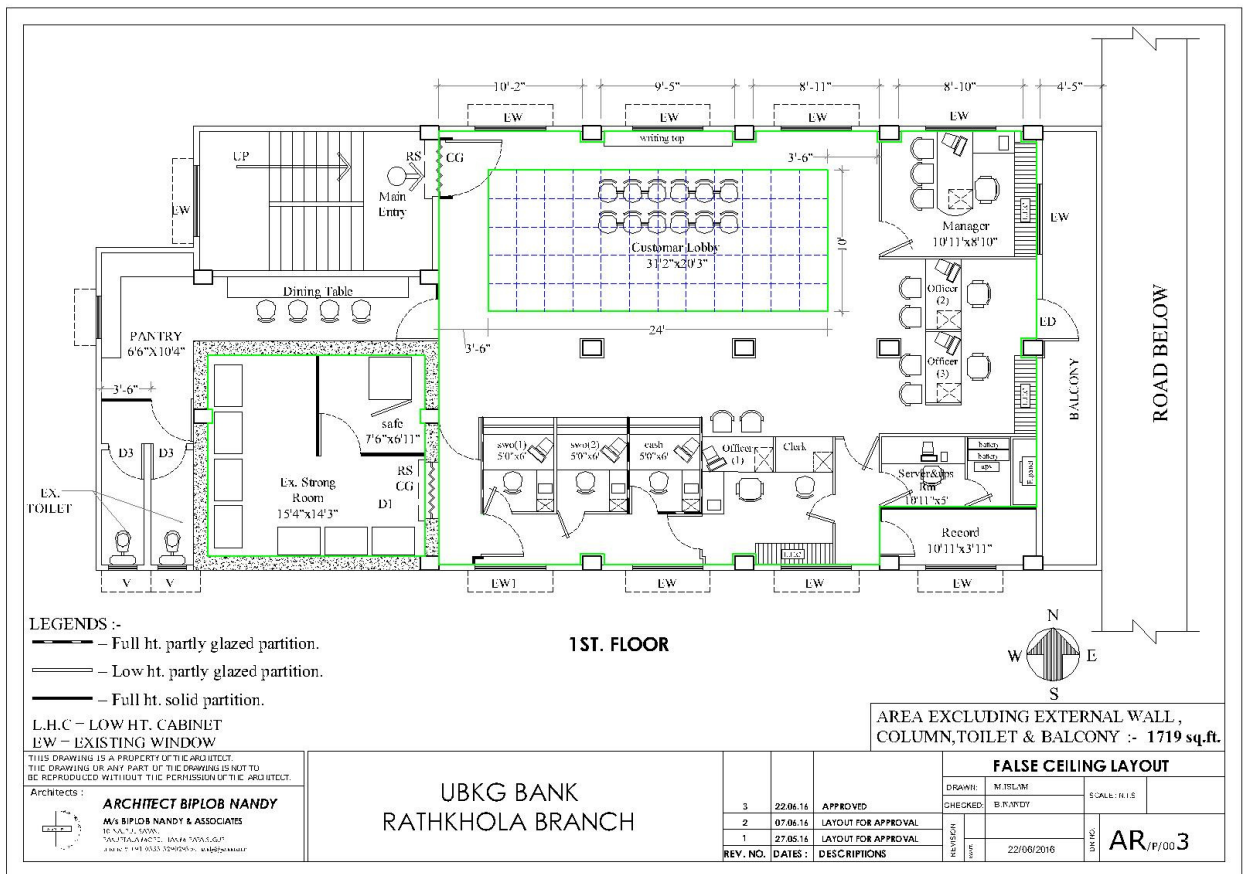

**UBKG BANK
RATHKHOLA BRANCH**

Architects : **ARCHITECT BIPOLO NANDY**
 M/A BIPOLO NANDY & ASSOCIATES
 10, SA. 72, SA. 50,
 "SANTAPUR" - DAKA - 1205, G.P.
 PH: 9913333290/3333333333